



TWB-15035

## 150' x 35' Inland Cutter Concept

This inland cutter concept was developed in response to a USCG request for information to help identify the vessel that best meets their operational needs. Several inland operating locations and missions were identified, which resulted in the configuration depicted here. Typical missions include brush clearing, setting, salvage & repositioning of aids to navigation (buoys, beacons & lights), launch and retrieval of service boats, pushing construction barges, driving piles, and search and rescue.

Crowley's engineering services team delivers a full range of marine and engineering solutions. This includes detail and conceptual design, shipyard management, and on-site consulting services for all types of marine projects anywhere in the world. Our vessel design and marine engineering services are both extraordinary and cost effective. No matter the size and scope of your marine project, our professionals will help you achieve your objectives in the safest and most efficient manner possible.

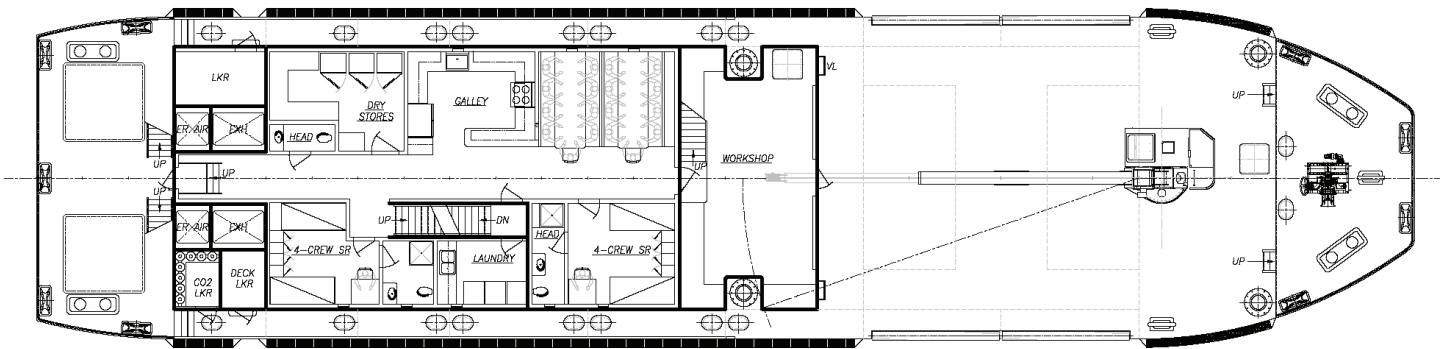
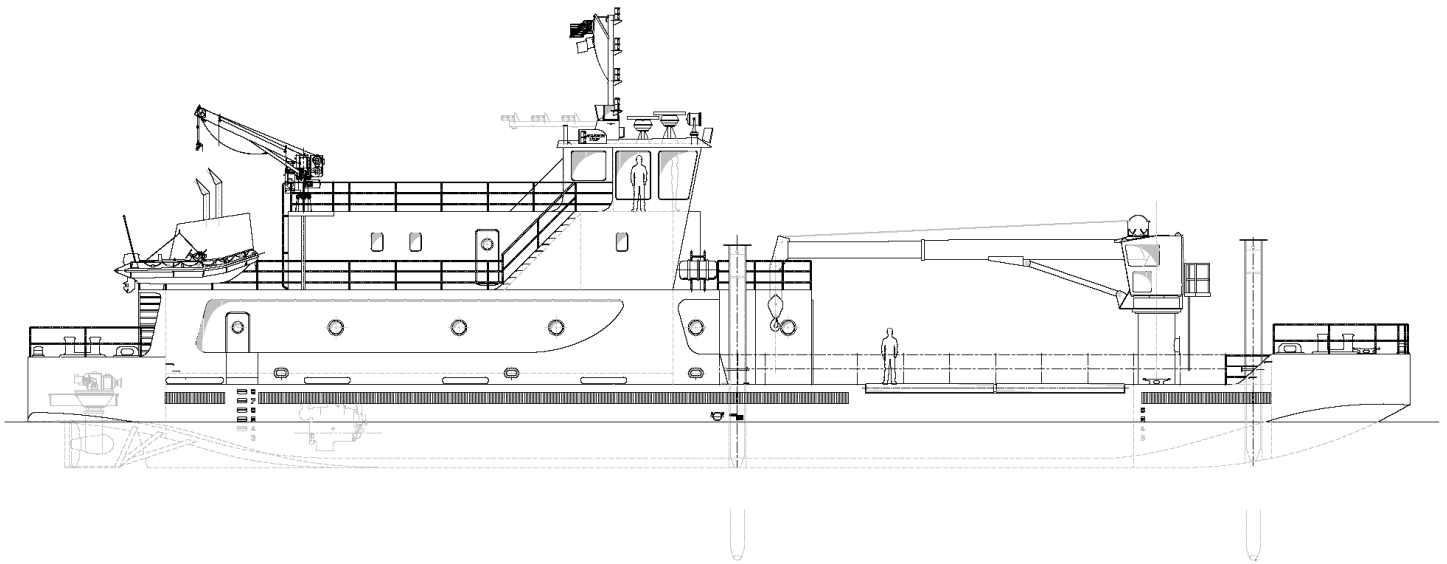

# Vessel Specifications

## Overall Dimensions

Length	150'-0" (45.7 m)	Main Engines	Caterpillar
Breadth	35'-0" (10.7 m)	Horsepower	2000 HP (1491 KW)
Depth	9'-0" (2.7 m)	Fuel Capacity	46,170 gal (175m <sup>3</sup> )
Draft	5'-0" (1.5 m)	Fresh Water	13,196 gal (50 m <sup>3</sup> )
Propulsion	Twin Screw, Z-Drive	Berths	18

206.332.8090

[crowley.com/vesseldesign](http://crowley.com/vesseldesign)

Seattle, WA • Jacksonville, FL

**CROWLEY®**  
People Who Know®