



THS-09238

92' x 38' ASD Tug

Jensen designed two 92-foot, 50-ton-bollard-pull Azimuth Stern Drive (ASD) tugboats for Caribbean TugZ, an affiliate of SEACOR Holdings Inc., for operation in the Caribbean and Gulf of Mexico. The pair of tugboats, built at Great Lakes Shipyard in Cleveland, meet a wide range of operational parameters, including ship assist, tanker escort, and emergency firefighting duties.

Tugs are outfitted with a pair of Caterpillar C280-6 Tier 2 diesel engines, rated at 2,320 hp at 900 RPM each, and two Rolls-Royce US 205FP Z-drives with 90" diameter wheels. The tugs can reach a speed of 14 knots, and have a bollard pull of more than 126,000 pounds ahead. These tugs have been specifically designed with environmental protection in mind. Oil tanks have been isolated from the hull, which reduces the chances of an oil spill in the event the hull is breached.

This feature is neither standard nor required, but was added to protect the environmentally sensitive areas where these vessels will operate.

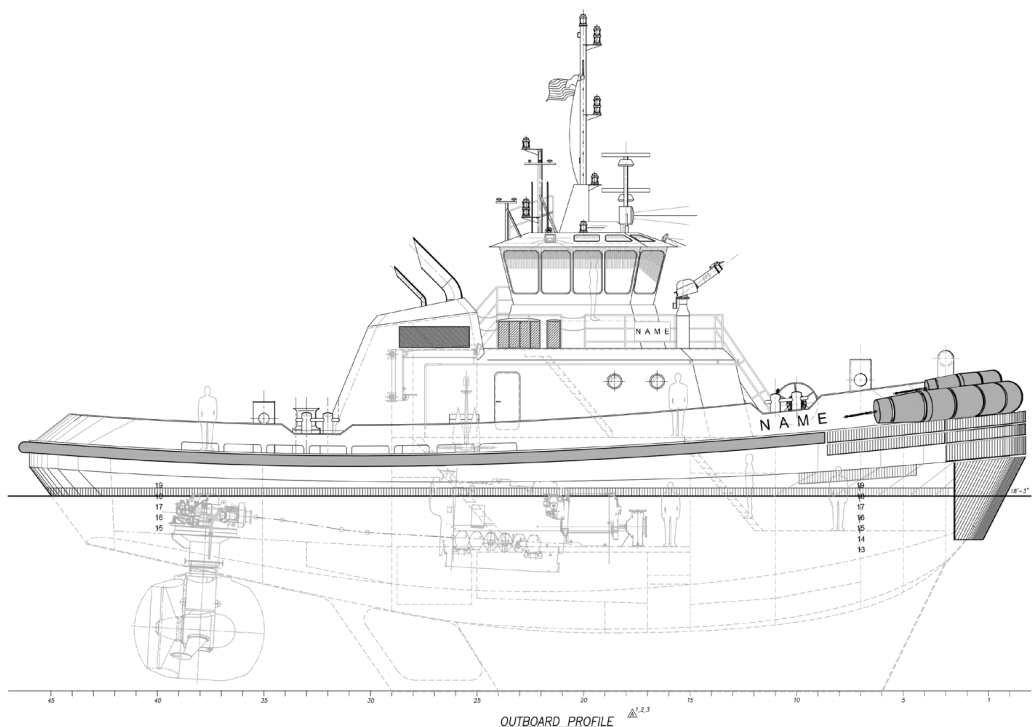

OUTBOARD PROFILE

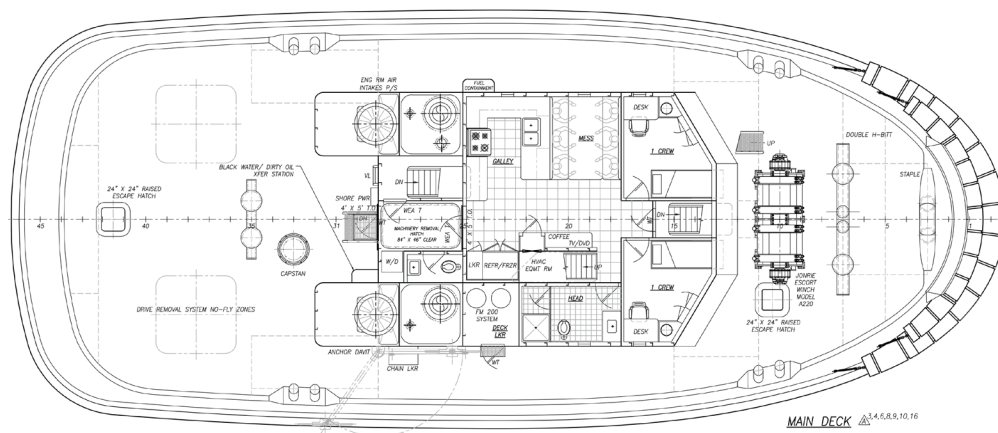

MAIN DECK

Vessel Specifications

Overall Dimensions

Length	92'-0" (28 m)	Fuel Oil	38,325 gal
Breadth	38'-0" (11.5 m)	Lube Oil	500 gal
Depth	16'-9" (5 m)	Fresh Water	2,500 gal
Propulsion	2 x CAT C280-6, 2320 HP each 2 x RR US 205 FP Z-Drives	Bollard Pull	50 MT Minimum
Fire Fighting	2 x 5,280 GPM Monitors ABS FFV1 Class	Tonnage	US Regulatory <200 International <400
Fire Fighting Foam	1,500 gal	Construction	Steel

206.332.8090

crowley.com/vesseldesign

Seattle, WA • Jacksonville, FL

CROWLEY®
People Who Know®