



FTR-11340

## RSW Trawler

Jensen trawlers are designed to take the worst the Bering Sea can throw at them, while providing a stable working platform for their crews. Each design is optimized to suit the particular needs of the operators, including cargo storage & refrigeration, fishing and processing productivity, offload speed, crew comfort & safety, noise reduction, operations in ice, tonnage and classification.

These vessels are configured with easy-to-build single-chine hulls, which offer a balanced compromise between construction cost and hydrodynamic hull efficiency. They can also be configured with molded (non-chine) hulls with developable surfaces when hull efficiency is a primary consideration.

Crowley's engineering services team delivers a full range of marine and engineering solutions. This includes detail and conceptual design, shipyard management, and on-site consulting services for all types of marine projects anywhere in the world. Our vessel design and marine engineering services are both extraordinary and cost effective. No matter the size and scope of your marine project, our professionals will help you achieve your objectives in the safest and most efficient manner possible.

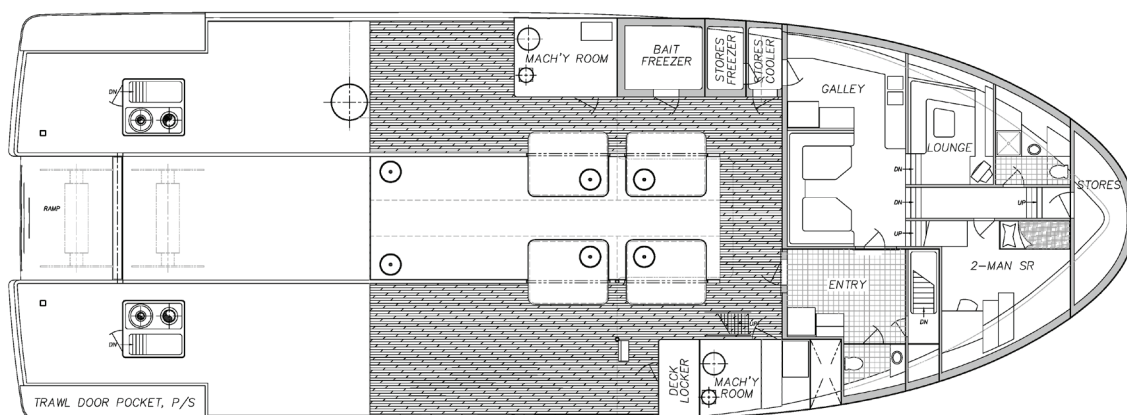
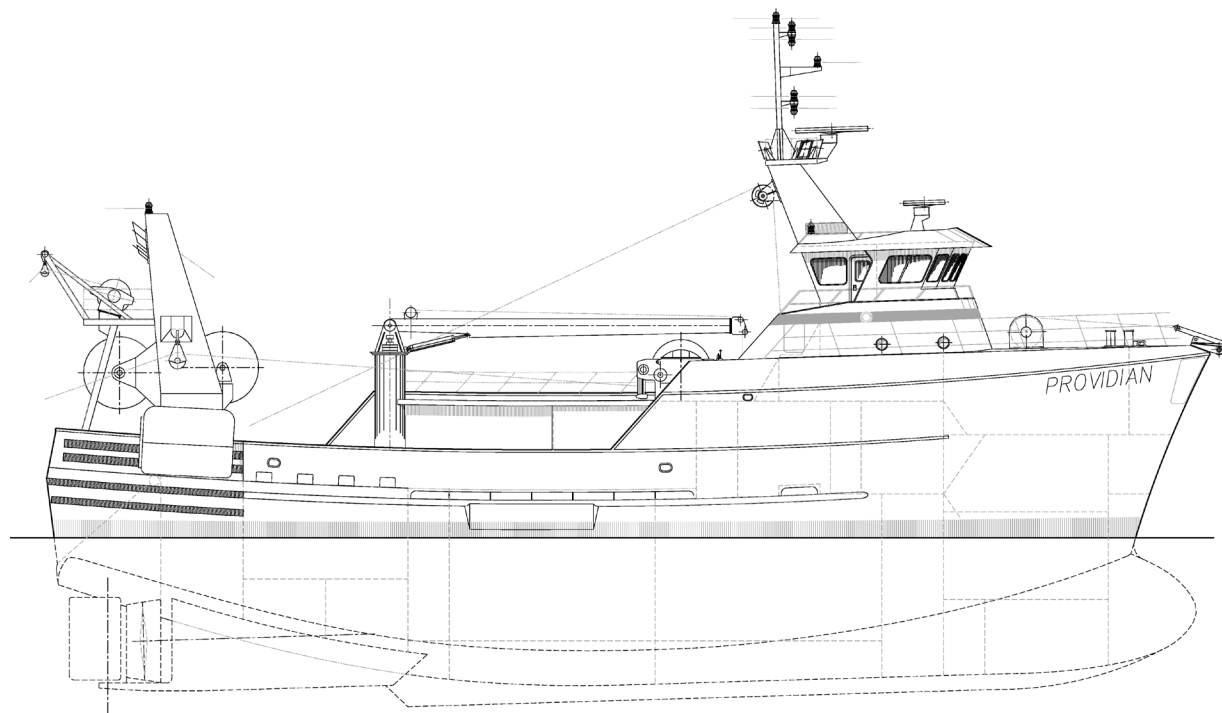

# Vessel Specifications

## Overall Dimensions

Length	112'-10" (34.4 m)	Hold Capacity	20,012 ft <sup>3</sup> (567 m <sup>3</sup> )
Breadth	40'-0" (12.2 m)	Fuel Capacity	51,437 gal (195 m <sup>3</sup> )
Depth	18'-0" (5.5 m)	Fresh Water	7,486 gal (28.3 m <sup>3</sup> )
Propulsion	Twin Screw, Fixed Pitch	Berths	9
Propulsion Power	3,000 HP (2,237 KW)	Gross Tonnage	476 US, 532 ITC

206.332.8090

[crowley.com/vesseldesign](http://crowley.com/vesseldesign)

Seattle, WA • Jacksonville, FL

**CROWLEY**<sup>®</sup>  
People Who Know<sup>®</sup>