

# Barge OB-3

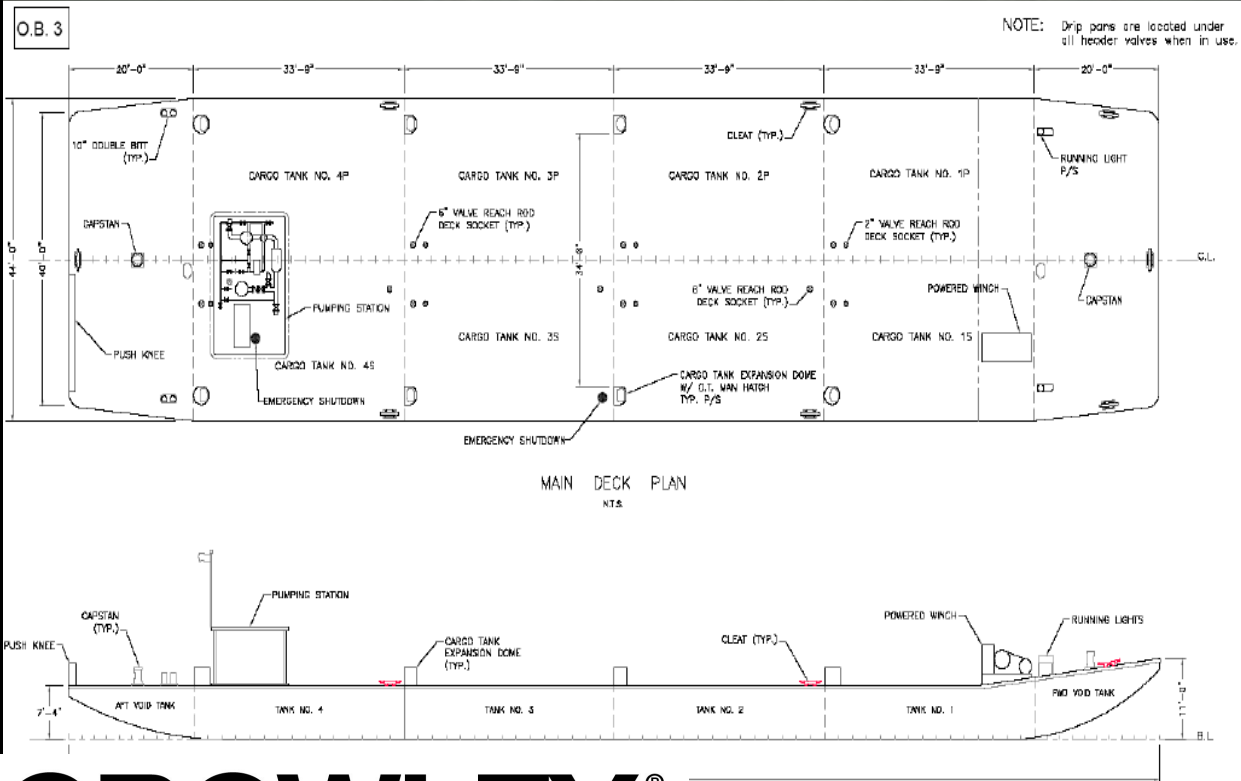

**CROWLEY**<sup>®</sup>  
People Who Know<sup>™</sup>

PRELIMINARY  
04-05-07  
NOT TO SCALE

## Barge OB-3



<b>Official No./Flag:</b>	0649570 / USA
<b>Home Port:</b>	Portland, OR
<b>Year Built:</b>	1953
<b>Length:</b>	175.0'
<b>Width:</b>	44.0'
<b>Depth:</b>	7.0'
<b>Light Draft:</b>	1.0'
<b>Working Draft:</b>	3.75'
<b>Tonnage NET/GROSS:</b>	447 Net tons / 447 Gross Tons
<b>Barge Capacity:</b>	319,234 Gallons 17,600 Barrels
<b>Capacity at Draft:</b>	580 tons. @ 3.75' draft
<b>Number of Tanks:</b>	(8) eight Product tanks / (1) bow & (1) stern voids.
<b>Tank Capacities:</b>	No. 1 P/S = 39,662 gal. (944 bbl.) No. 2 P/S 39,985 gal. (952 bbl.) No. 3 P/S = 39,985 gal. (952 bbl.) No. 4 P/S = 39,985 gal. (952 bbl.) Cargo pump fuel tank = 45 gal.
<b>Lube oil tank, Fresh Water Tank:</b>	Not equipped
<b>COI Route Permitted:</b>	Rivers; Yukon River and its Tributaries.
<b>Cargo Pump:</b>	(1) 6" Deep well type W/ Detroit 3-53 Engine.
<b>Winch:</b>	(2) drum Bow winch WI Detroit 2-71 Engine. Certified to carry Grade -B or lower Petroleum, combination
<b>Cargo Grade:</b>	<ul style="list-style-type: none"><li>• Gasoline Jet Fuel JP-4 Grade -B</li><li>• Some solvents Grade -C</li><li>• Diesel fuel Grade -D</li></ul>

**CROWLEY**<sup>®</sup>  
People Who Know<sup>™</sup>

201 Arctic Slope Ave  
Anchorage, AK 99518  
(907) 777-5505  
www.crowley.com