



TLH-12035

120' x 35' Line Haul Tug

This 120' x 35' Line Haul Tug is based on the successful Titan class tugboats as part of Crowley's continued commitment to meeting the ocean towing needs of its project management customers. Powered by twin GE 8L250 EPA Tier II engines, each rated at 2679 HP/1999KW @ 900 RPM, the ABS Maltese Cross A1, Towing Service, Machinery-Classed vessel consumes significantly less fuel and enjoys much lower maintenance costs than other equivalently powered oceangoing tugboats. The tug is fitted with a pair of Schottel 1515 Z-drive units for superior maneuverability of tows in port and in close quarters. Measuring 494 International tons and 99 US Regulatory tons, the tug is qualified to sail in all U.S and worldwide waters with the smallest possible crew.

Overall Dimensions

Overall Length.....	120'	Double-Drum Winch	JonRie Series 500
Molded Breadth	35'	Headline Winch	JonRie Series 200
Molded Depth	21'	Tonnage	99 US Regulatory 494 International
Bollard Pull.....	80 ST	Horsepower	Total 5358 @ 900 RPM
Crew Complement	4-11	Main Propulsion.....	2 x GE 8L250
Certifications	ABS + A1, AMS Machinery Class, Towing Service All Oceans	Z-Drive Thrusters	2 x Schottel 1515FP, 2600 MM Diameter Stainless Propeller
Navigation Equipment	Dual Radars, Satellite Communication, VHF Radios	Ship's Service Power.....	2 x John Deere 6081A/ Kohler Generators, 180 kW
Fuel Capacity.....	154,914 gal	Emergency Tow Line.....	600'-7" Dyneema Towing Package
Fresh Water	14,058 gal		

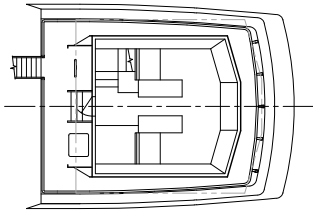

BRIDGE DECK

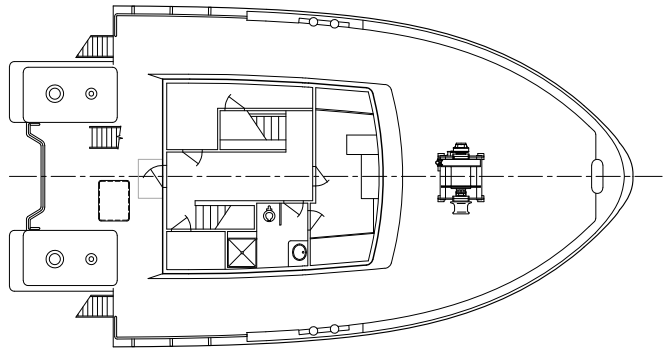

FOC'SLE DECK

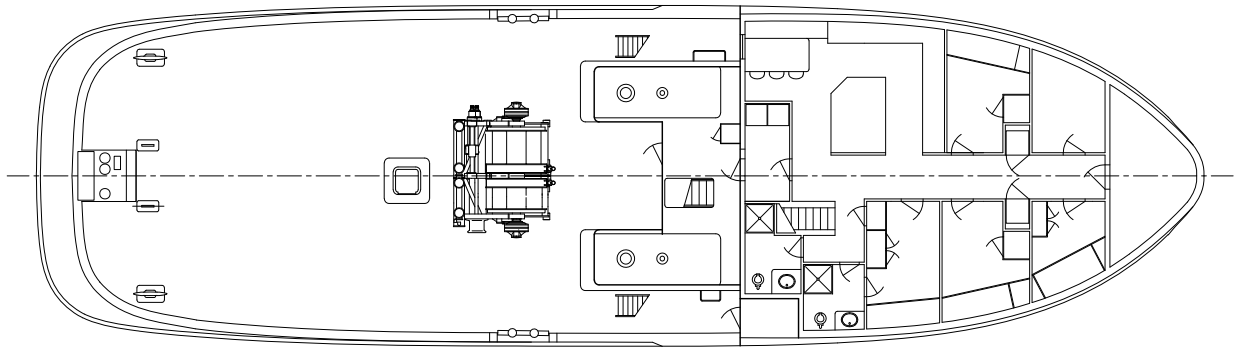

MAIN DECK

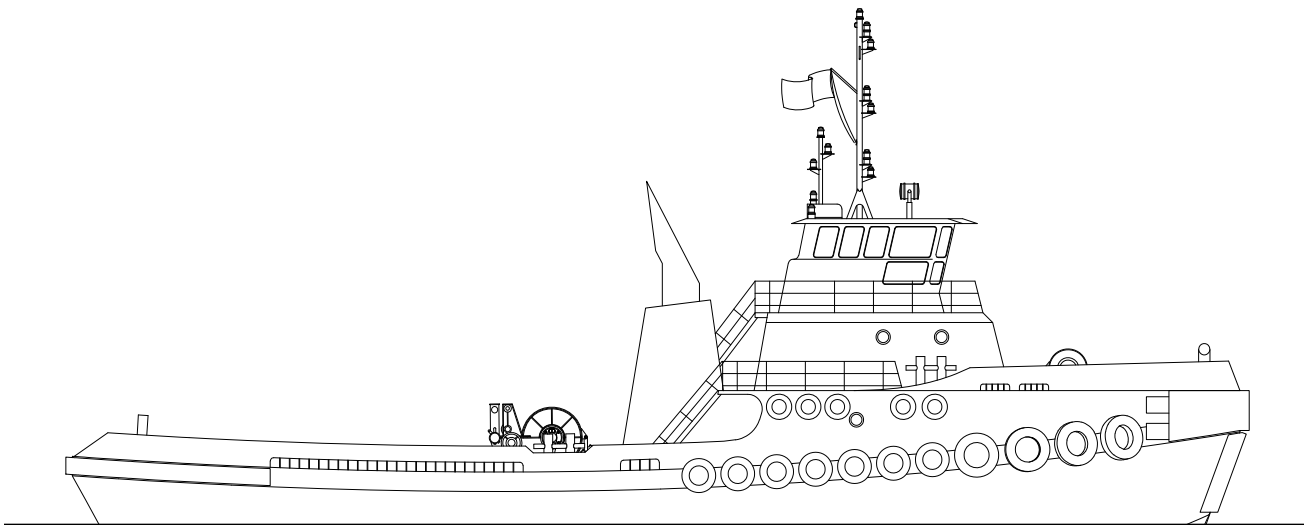

OUTBOARD PROFILE